

- NOTES:**
1. ALL COORDINATES ARE TO THE ITM (IRISH TRANSVERSE MERCATOR) GEOGRAPHIC COORDINATE SYSTEM.
 2. ALL LEVELS ARE TO ORDNANCE DATUM IRELAND (MALN HEAD).
 3. ALL DIMENSIONS ARE IN METRES UNLESS SPECIFIED OTHERWISE.
 4. ALL AGGREGATES PROPOSED FOR USE ON THIS SCHEME SHALL MEET FULLY THE REQUIREMENTS OF THE CONTRACT SPECIFICATION AND, IN ADDITION, THE REQUIREMENTS STATED IN STANDARD RECOMMENDATION SR 21-2015 - GUIDANCE ON THE USE OF IS EN 12620 + A1:2007 - AGGREGATES FOR UNBOUND AND HYDRAULICALLY BOUND MATERIALS FOR USE IN CIVIL ENGINEERING WORK AND ROAD CONSTRUCTION. FURTHER DETAIL IS PROVIDED IN ADDITIONAL CLAUSE 14.4.4R OF THE CONTRACT SPECIFICATION.
 5. ALL MATERIAL DISPOSED OFF SITE SHALL BE TAKEN TO A LICENSED FACILITY APPROVED BY THE OVERSEEING AUTHORITY.
 6. PRIOR TO THE INSTALLATION OF ANY PIPED SERVICES OR ACCESS POINTS ROUTED NEAR TREES OR HEDGES, THE INSTALLATION CONTRACTOR IS TO PREPARE A METHOD STATEMENT, IN CONJUNCTION WITH THE PROJECT ARBORICULTURALIST AND ENGINEER, FOR THE INSTALLATION OF THESE SERVICES OR ACCESSES WHILE PROVIDING PROTECTION TO THE EXISTING TREE VEGETATION SHOWN FOR RETENTION.

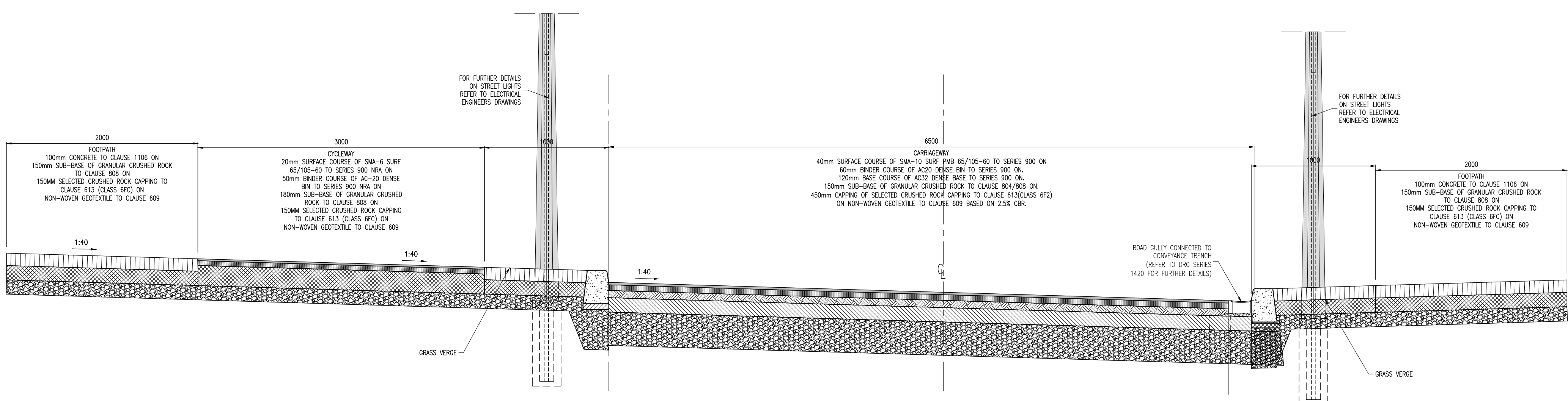

TYPICAL LOCAL DISTRIBUTOR ROAD
SECTION A-A
SCALE 1:30

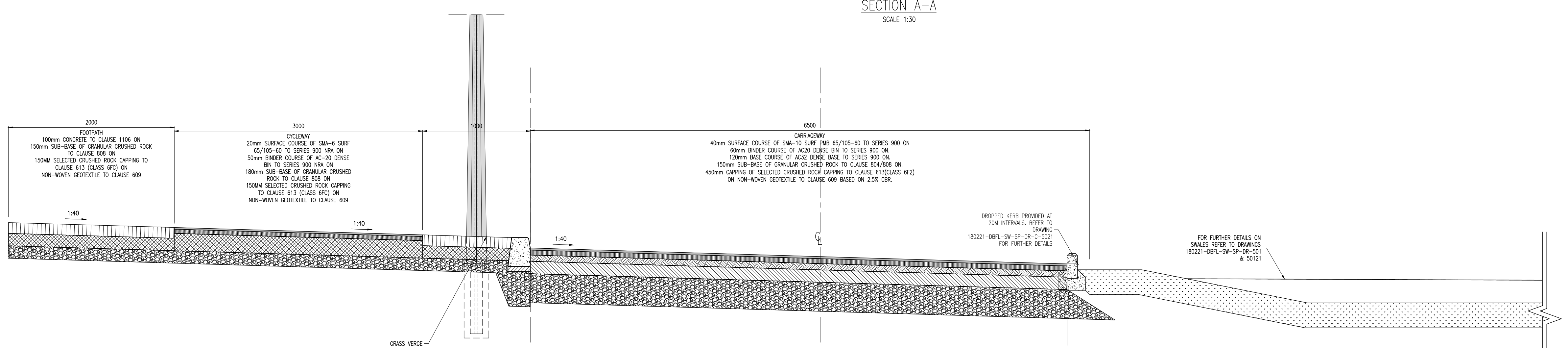

TYPICAL LOCAL DISTRIBUTOR ROAD
SECTION B-B (OPPOSITE BIO SWALES)
SCALE 1:30

- DRAWING SPECIFIC NOTES:**
1. ALL ROAD RELATED WORKS SHALL BE CONSTRUCTED IN ACCORDANCE WITH RECOMMENDATIONS FOR SITE DEVELOPMENT WORKS FOR HOUSING AREAS UNLESS OVERRIDDEN BY LOCAL AUTHORITY STANDARDS AND AS DIRECTED OTHERWISE.
 2. FOR PROJECT SPECIFIC CONSTRUCTION DETAILS REFER TO DRAWING SERIES 5000
 3. ALL BITUMINOUS MATERIALS SHALL BE LAID & COMPACTED IN ACCORDANCE WITH TI SPECIFICATION FOR ROAD WORKS SERIES 700 & 900 UNLESS DIRECTED OTHERWISE.
 4. ALL GRANULAR SUB BASE MATERIAL SHALL MEET THE REQUIREMENTS OF CLAUSE 804 AND CLAUSE 808 OF THE TI SPECIFICATION FOR ROAD WORKS.
 5. ALL CAPPING MATERIAL SHALL BE CLASS 6P2 TO CLAUSE 613 OF THE TI SPECIFICATION FOR ROAD WORKS.
 6. ANY ROADS PROPOSED TO BE USED FOR CONSTRUCTION TRAFFIC ARE TO HAVE INCREASED DEPTH OF SUB-BASE TO THE REQUIREMENTS OF THE ENGINEER.

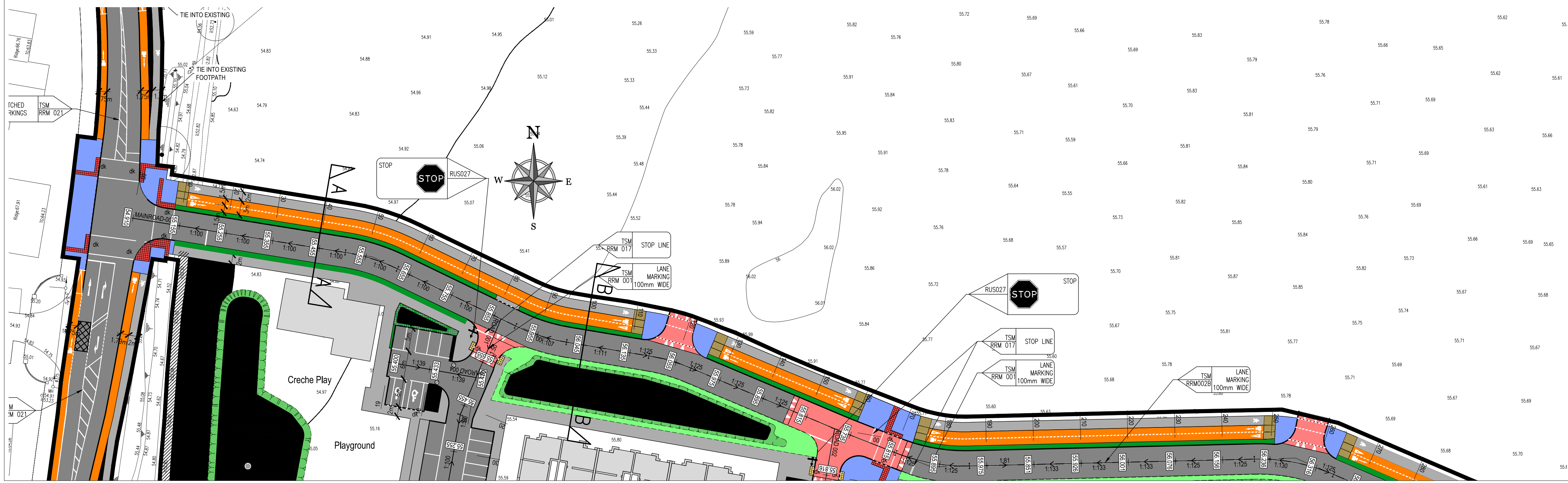

P03	09-08-22	PLANNING SUBMISSION	ICJ	NOH
P02	23-02-22	Formal Submission	PLY	NOH
P01	21-01-22	FOR PLANNING	PLY	NOH
rev	date	description	by	chkd.
		A - Approved		
		B - Approved with comments		
		C - Do not use		
client approval		issue purpose		
S4 - STAGE APPROVAL		PLANNING		

DBFL Consulting Engineers
Civil, Structural & Transportation Engineering
www.dbfl.ie

DUBLIN OFFICE: Ormond House, Upper Ormond Quay, Dublin 7, D07 W704
PHONE: +353 1 406 4000
CORK OFFICE: Phoenix House, Monahan Road, Cork, T12 H1XV
PHONE: +353 (0) 21 2054538
WATERFORD OFFICE: Suite 10 The Atrium, Maritime Gate, Canada Street, Waterford, X91 W028
PHONE: +353 51 309 500

project ref.
**BALLYOULSTER KDA SHD - PHASE 1
RESIDENTIAL DEVELOPMENT**

drawing title
ROAD SECTION DETAILS SHEET 2

client
**KIERAN CURTIN, RECEIVER OVER
CERTAIN ASSETS OF MAPLEWOOD
DEVELOPMENTS UNLIMITED COMPANY**

designed by
GIS

author
RMC

scale
AS SHOWN

sheet size
A1

drawing no.
180221-DBFL-RD-SP-DR-C-3003

revision
P03